

QUASAR

Chain Actuator – Force in push action 300 N – Maximum stroke 500 mm



- **Highest performance in minimum size:** the casing in die-cast aluminium has a very small section (47 x 32 mm) and can be easily built-in into the frame of continuous facades.
- New concept **double link chain** completely in **stainless steel**.
- Quick and easy installation: manual closing position regulation is not required, avoiding possible mistake. The stop in closing position is regulated by an electronic limit switch.
- Low noise operation.
- Electronic stop in the intermediate positions in case of overload.
- Supplied with wired terminal board with 1,5m cable.
- No additional brackets are needed for windows with windowsill.
- For windows without windowsill or of a length inferior to 1500 mm install the pivoting brackets kit (included).
- Quick release system for easy window cleaning.

	QUASAR AC	QUASAR DC
VOLTAGE SUPPLY	100 Vac - 240 Vac	24 V dc ±10%
STROKE	500 mm	500 mm
FORCE	300 N	300 N
SPEED	~ 15 mm/s	~ 15 mm/s
MAX CURRENT ABSORPTION	0,4 A - 0,2 A	0,9 A
PARALLEL CONNECTION	YES	YES
LIMIT STOP	Electronic	Electronic
SAFETY STOP	Electronic	Electronic
TIME RATING	50%	50%
PROTECTION CLASS	IP 30	IP 30

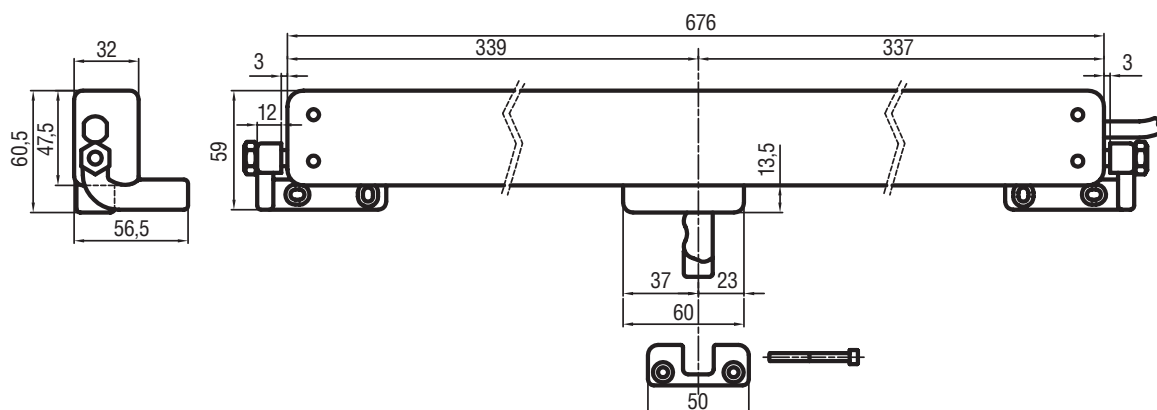
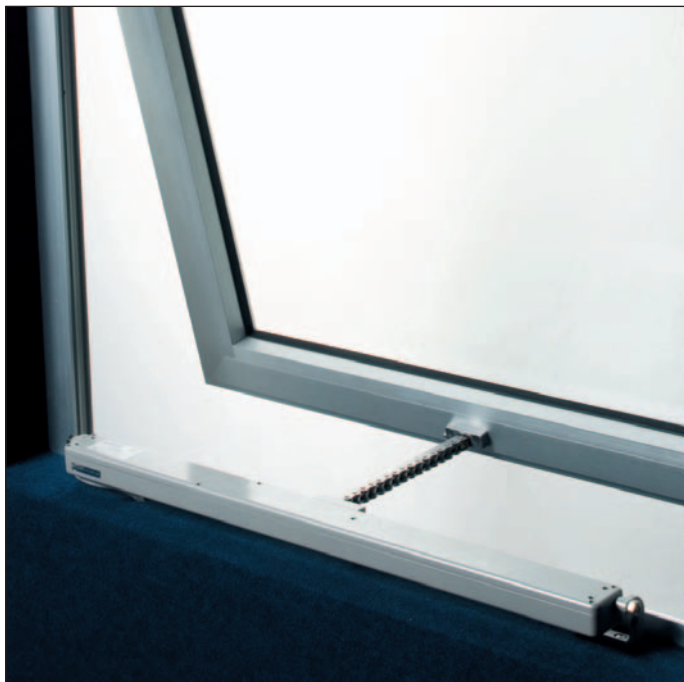

Actuator dim.

SPECIFICATION PROSPECTS

Electric chain actuator Ultraflex Control Systems named Quasar with double link chain completely in stainless steel. Voltage supply: from 100 to 240 Vac or 24 Vdc - Electronic limit stop; electronic stop in the intermediate positions in case of overload.

Casing in painted die-cast aluminium with very small section (47x32 mm).

Pivoting brackets included.

The 100-240 Vac version and the 24 Vdc version are conform to 89/336 EMC directives as modified per 93/68 CE, the 100-240 Vac version is conform to 73/23 LVD directives.

Installation examples

green line

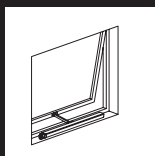

Top hinged windows

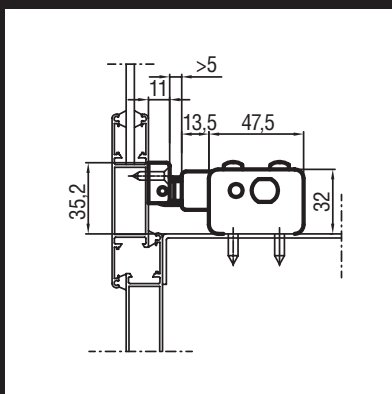

On windows with windowsill

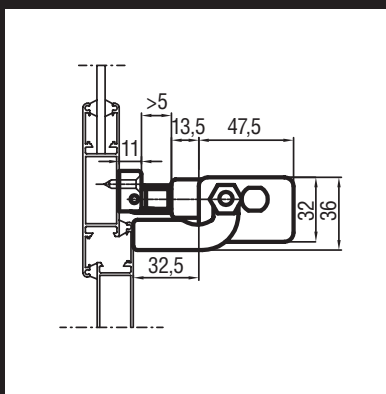

On windows without windowsill with pivoting brackets kit included

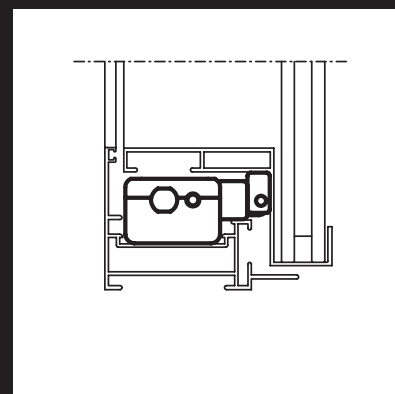

Inside a curtain wall frame

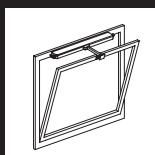

Bottom hinged windows

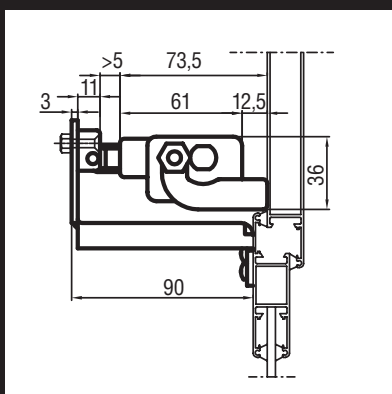

On the frame with pivoting brackets kit and bracket for bottom hinged windows part No. 40858U

⚠ The instructions for a safe installation are included in the section "SECURITY WARNINGS"

Accessories

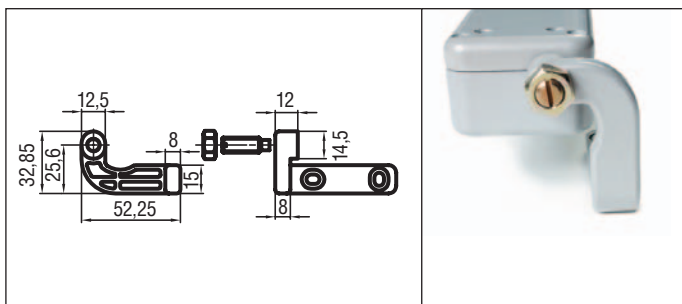

Pivoting brackets kit (included)

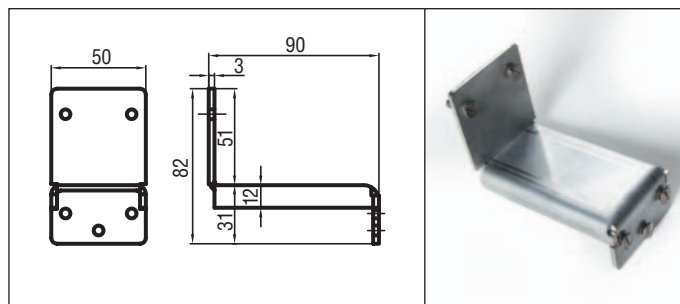

Stainless steel bottom hinged window bracket part No. 40858U